

Soldering Reflow:

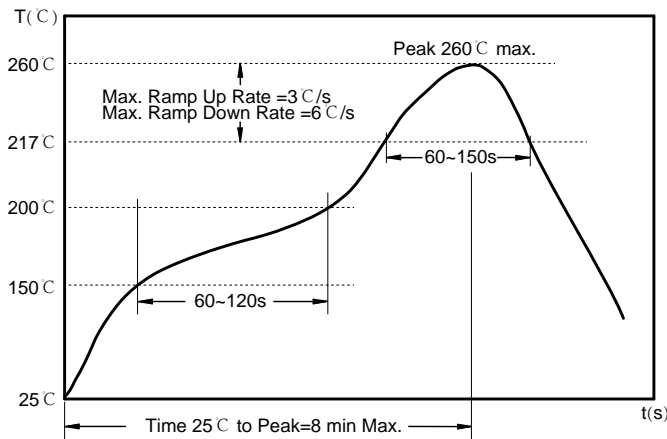

Preheat condition: 150 ~200 °C / 60~120 sec.

Allowed time above 217 °C: 60~150 sec.

Max temperature: 260 °C.

Allowed Reflow time: 2x max.

Packaging Information:

Tape Dimension:

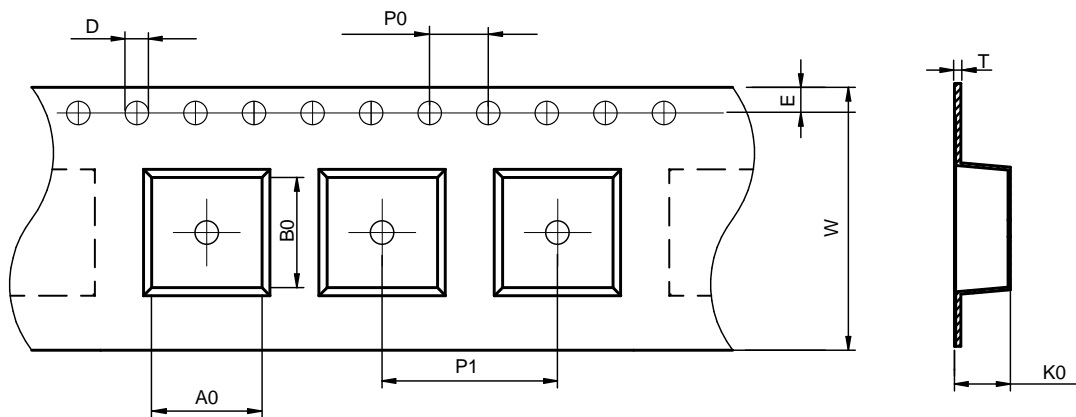

| Series | A0 (mm) | B0 (mm) | D (mm) | P0 (mm) | P1 (mm) | W (mm) | K0 (mm) | E (mm) | T (mm) |
|---------|---------|---------|---------|---------|----------|----------|---------|----------|---------|
| SCM9250 | 6.5 typ | 9.7 typ | 1.5±0.1 | 4.0±0.1 | 12.0±0.1 | 16.0±0.3 | 5.7 ref | 1.75±0.1 | 0.4±0.1 |

Peel force of top cover tape:

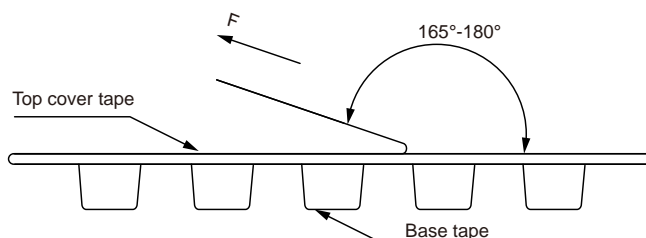

The peel force of top cover tape shall be between 0.1 to 1.3 N

Product Marking:

| | |
|---------|---|
| Marking | Dot+Printing (Duplex winding) /Printing (Split winding) |
|---------|---|

Reel Dimension : [mm]

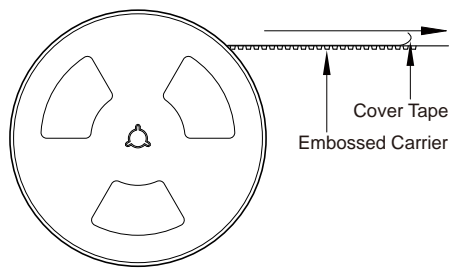

2.2±0.5

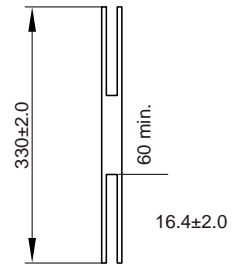

Packaging Quantity:

1000 Pcs/Reel

2 Reel /Inner box(2000 Pcs)

3 Inner box/Carton box(6K Pcs)

Cautions and Warnings:

Storage Conditions:

Operation Instructions: