

# MDE Series

## Molding Power Inductors

### Size 252010S

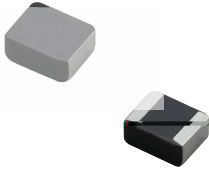

#### FEATURES

- High saturation current realized by material properties and structure design.
- 
- 
- 
- 

#### APPLICATION

- Generic in portable DC to DC converter line.
- Smart phone, PAD
- DC/DC converter
- Thin-type power supply module.

#### Dimensions: [mm]

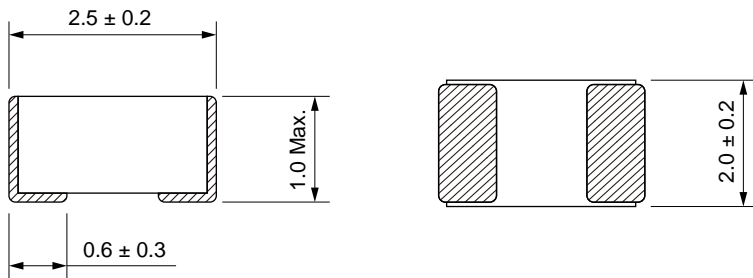

#### Land Pattern: [mm]

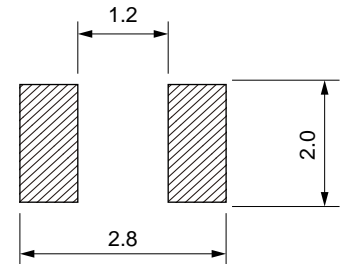

#### Electrical Properties:

Model	Inductance (mH)	Inductance Tolerance (%)	DC Resistance (mΩ)	DC Resistance (mΩ)	DC Resistance (mΩ)	DC Resistance (mΩ)	DC Resistance (mΩ)	DC Resistance (mΩ)
MDE252010S-R22M	0.22	±20%	10	13.5	10.5	9.0	6.9	6.3
MDE252010S-R24M	0.24	±20%	11.5	14.5	8.8	8.0	6.6	6.0
MDE252010S-R33M	0.33	±20%	17	22	7.8	7.0	5.6	4.8
MDE252010S-R47M	0.47	±20%	23	29	6.6	6.0	5.2	4.4
MDE252010S-R68M	0.68	±20%	30	36	5.5	5.0	4.3	3.7
MDE252010S-1R0M	1.00	±20%	41	52	4.4	4.0	3.4	3.1
MDE252010S-1R5M	1.50	±20%	62	72	3.8	3.4	2.9	2.5
MDE252010S-2R2M	2.20	±20%	88	110	3.3	3.0	2.4	2.1
MDE252010S-3R3M	3.30	±20%	140	160	2.5	2.2	1.9	1.6
MDE252010S-4R7M	4.70	±20%	200	240	2.2	1.9	1.6	1.4

Temperature rising current will cause the coil temperature approximate T40 °C  
 Saturation current will cause to drop approximately 30%

# Typical Electrical Characteristics:

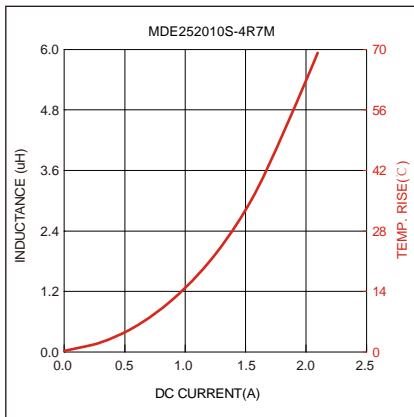
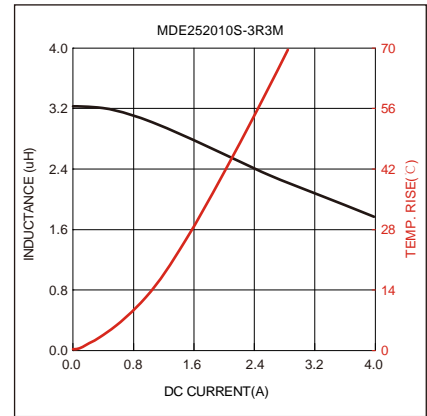
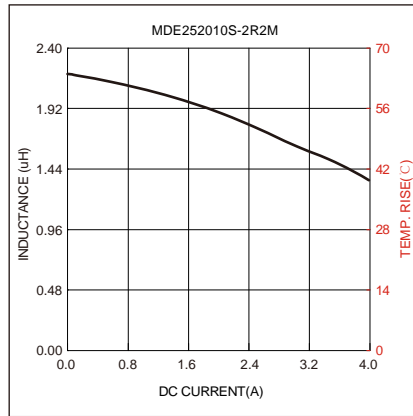
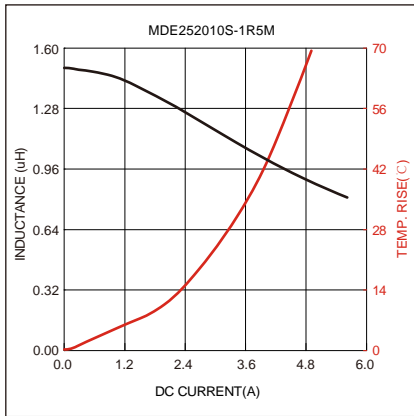
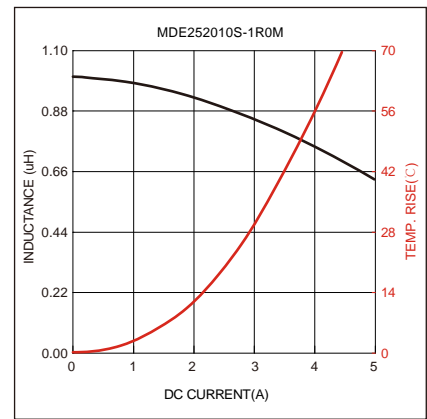
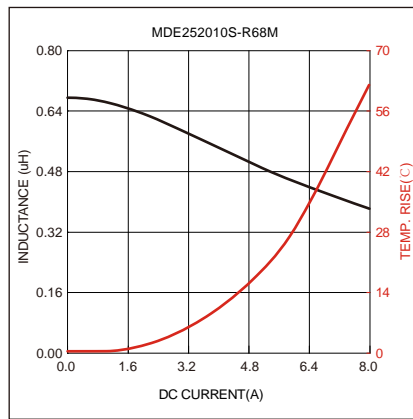
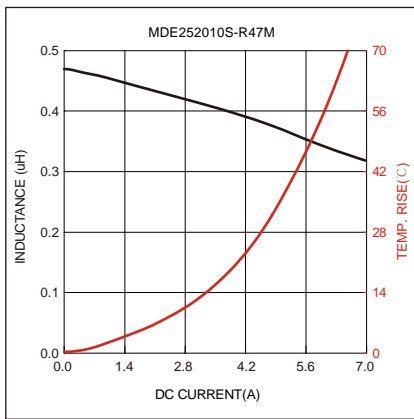
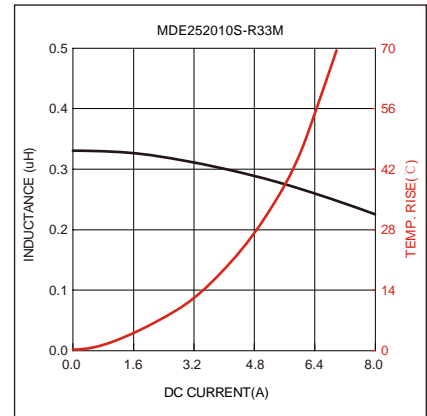
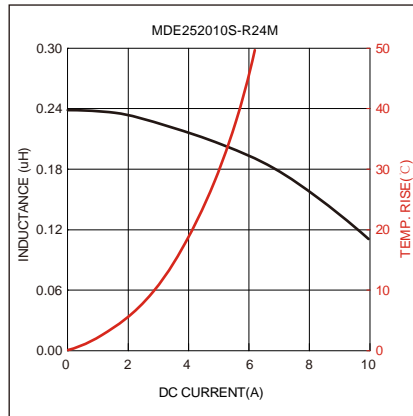
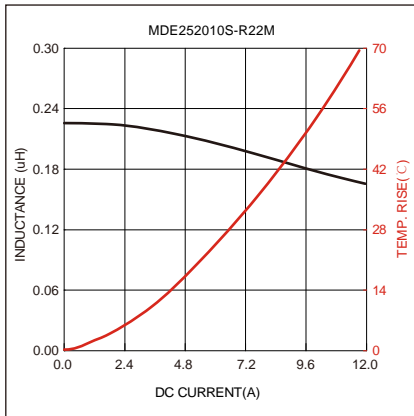

## Soldering Reflow:

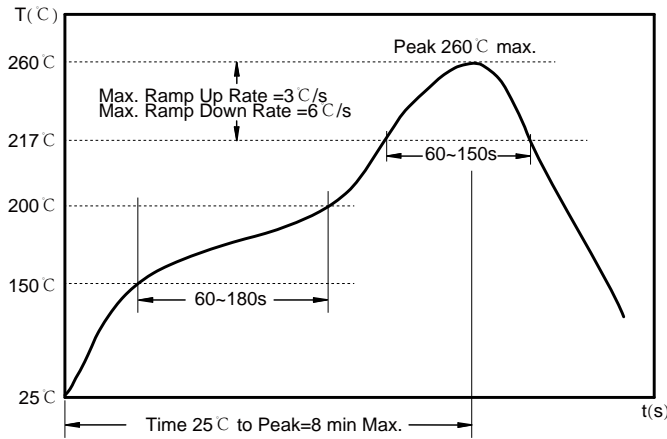

Preheat condition: 150 ~200 °C / 60~180 sec.

Allowed time above 217 °C : 60~150 sec.

Max temperature: 260 °C .

Time within 5 °C of actual Peak Temperature: 20-40 sec.

## Packaging Information:

### Tape Dimension:

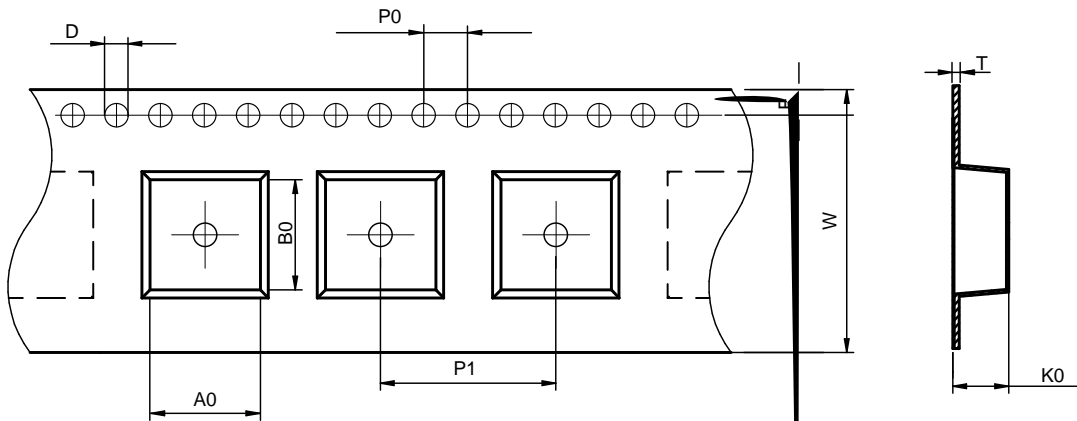

Series	A0 (mm)	B0 (mm)	D (mm)	P0 (mm)	P1 (mm)	W (mm)	K0 (mm)	E (mm)	T (mm)
MDE252010S	2.25±0.05	2.8±0.1	1.5±0.1	4.0±0.1	4.0±0.1	8.0±0.1	1.35±0.1	1.75±0.1	0.22±0.05

### Peel force of top cover tape:

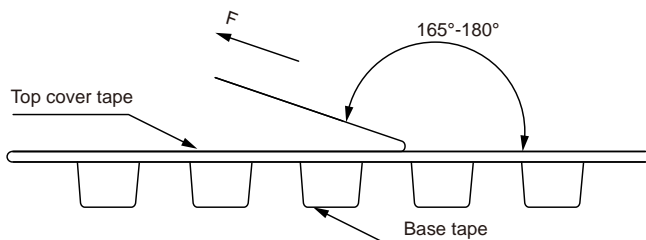

The peel force of top cover tape shall be between 0.1 to 1.3 N

