

# MDE Series



## FEATURES

- High saturation current realized by material properties and structure design.
- Low DC resistance to achieve high conversion efficiency and lower temperature rising.
- Low Profile.
- Magnetically shielded structure to accomplish high resolution in EMC protection.
- Halogen free, Lead Free, RoHS Compliance.
- Operating temperature: -40 to +125 °C
- Quantity: 3000PCS

## APPLICATION

- Generic in portable DC to DC converter line.
- DC/DC converter
- Thin-type power supply module.

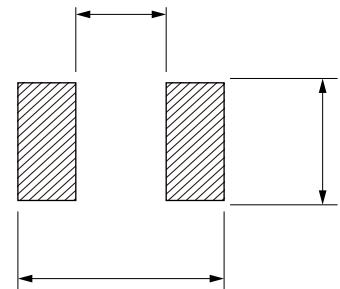
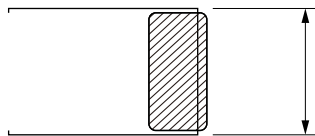
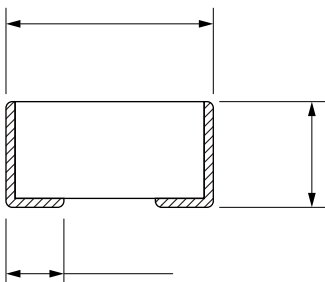

Part No	Inductance @ 1MHz/1V	Tolerance	DC Resistance Typ.	DC Resistance Max.	Current Typ.	Current Max.	Temperature Rise Current Typ.	Temperature Rise Current Max.

Temperature rising current will cause the coil temperature approximate T40 °C  
 Saturation current will cause to drop approximately 30%

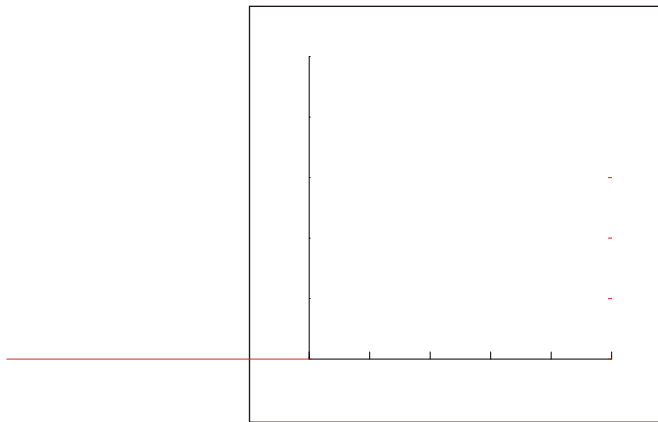
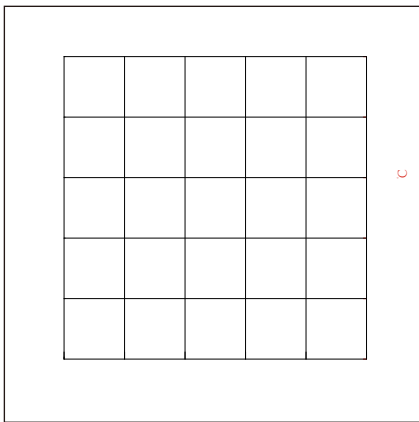
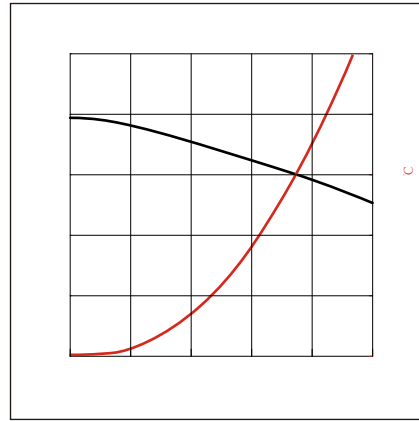
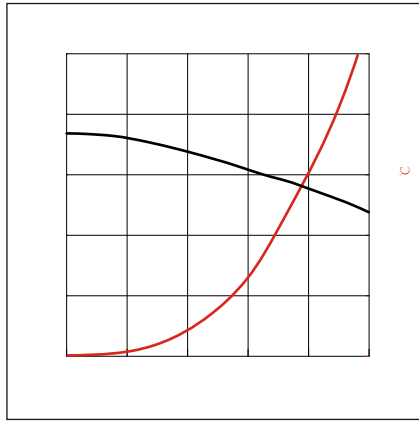
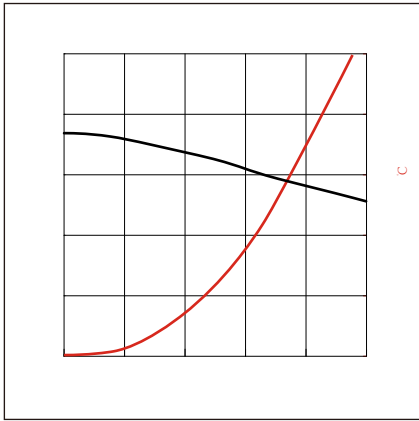

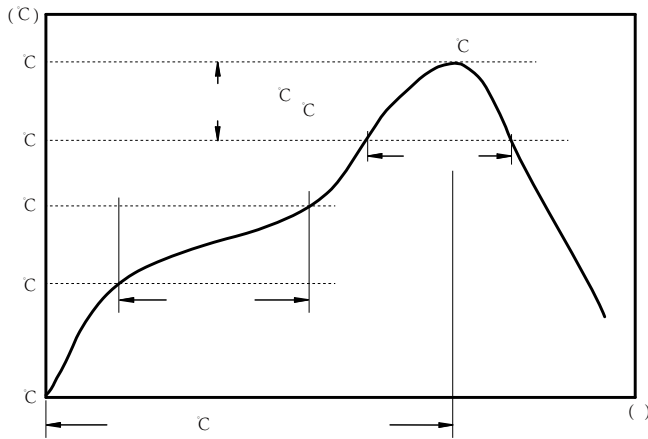

c  
c  
c  
c

:

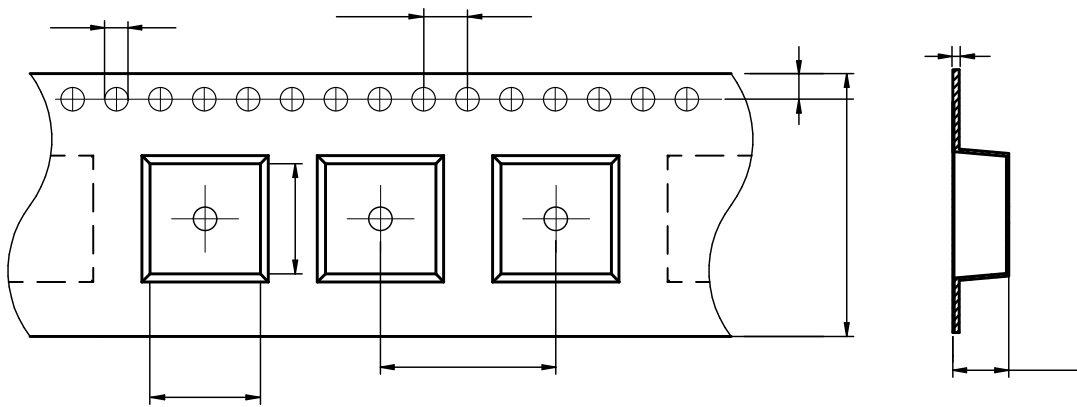

MDE201610	$1.82 \pm 0.05$	$2.23 \pm 0.05$	$1.55 \pm 0.05$	$4.0 \pm 0.1$	$4.0 \pm 0.1$	$8.0 \pm 0.3$	$1.15 \pm 0.05$	$1.75 \pm 0.1$	$0.22 \pm 0.05$

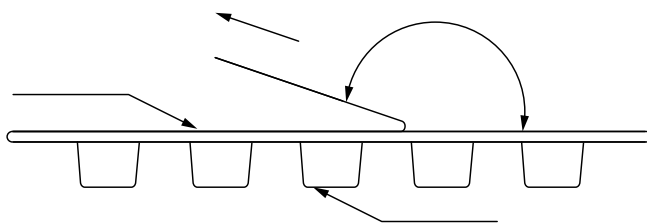

The peel force of top cover tape shall be between 0.1 to 1.3 N

:

